



Fire Station 27

Public Safety

North of Dacula off Old Fountain Road, Fire Station 27 is typical of the public safety improvements funded by SPLOST programs. The new station has two truck bays, offices, living quarters, and storage. Other new stations underway include Fire Station 28 on Rosebud Road near Loganville, a relocated Fire Station 7 with three bays and a new ladder company, and a replacement for Fire Station 1, the County's first fire station in Norcross.

Our new 50-acre **Police Training Facility** opened in June 2007 and includes a classroom building, fitness area, firing ranges, and a 21-acre driver-training course. Located on Winder Highway, the state-of-the-art complex is Gwinnett County's second project built to energy-efficient LEED® certification standards.

A much-needed new **Animal Welfare and Enforcement Center** opened to the public in September 2007. The new center is located at 884 Winder Highway in Lawrenceville. With 33,000 square feet, the new facility is more than double the size of the old shelter. It is equipped with state-of-the-art technology and the latest in animal care.

SPLOST and the 2007 Budget

Gwinnett County's capital and operating budgets for 2007 show the dramatic impact that SPLOST

programs have had. Especially in the areas of transportation and parks, the additional SPLOST funds have allowed traditional tax revenues to expand other basic services and keep up with a rapidly growing population. For example, the County added 211 new jobs in this year's operating budget, with 172 of them going to public safety, the sheriff's department, and the courts.

Operating Budget	\$ 815,169,167
Capital Budget	\$ 800,236,564
TOTAL	\$1,615,405,731

The 15 cities in Gwinnett will receive an estimated \$88.6 million from the current SPLOST program. Revenues are monitored monthly. To allow for unexpected shortfalls, the County budgets only 90 percent of expected SPLOST revenue. Any additional income will be allocated later to the same voter-approved categories listed below.

Transportation	\$162,000,000
Parks and Recreation	\$162,000,000
Public Safety	\$ 78,821,640
Libraries	\$ 12,420,000
Cities Share	\$ 88,620,400
TOTAL	\$503,862,040

**gwinnettcounty
board of commissioners**

75 langley drive
lawrenceville, ga 30045
770.822.8000

www.gwinnettcounty.com

**sales tax
program update**
your pennies
at work



gwinnettcounty
fall **2007**



About SPLOST

One penny of every dollar spent in Gwinnett County pays for specified capital improvements throughout the county. The current Special Purpose Local Option Sales Tax (SPLOST) program went into effect in April 2005.

The four-year program is expected to raise about \$500 million, to be shared between County and city governments and used for transportation, parks and recreation, public safety, and libraries. By using sales tax funds for these improvements, the County has been able to minimize long-term debt and hold property taxes steady.

Citizen committees studied and prioritized many proposed transportation and parks projects and made recommendations to the Board of Commissioners. The County's long-range planning and master plan documents also help guide this process.

Gwinnett voters have approved a series of previous SPLOST programs since the mid-1980s that have paid for such projects as the **Gwinnett Justice and Administration Center**, the **Gwinnett Center**, many acres of greenspace, new parks and recreation facilities, **Sugarloaf Parkway**, **Satellite Boulevard** and hundreds of other road improvements, new police and fire stations, and libraries around the county.

This brochure highlights just a few of the County's SPLOST-funded projects that are currently underway. These and many other improvements will continue to have a dramatic impact on the quality of life in Gwinnett County.

Transportation

Among many other road improvement projects, sales tax dollars are helping widen two major roads in the Mall of Georgia and Gwinnett Place areas. **Gravel Springs Road** from State Route 20/Buford Drive to I-85 and from I-85 to State 124/Braselton Highway is currently under construction. Rights-of-way are being purchased for wid-

ening **Pleasant Hill Road** from Old Norcross Road to Buford Highway.

Engineering and land acquisition are underway to extend **Sugarloaf Parkway** from State Route 20/Grayson Highway to State Route 316 east of Lawrenceville. Construction of Phase One (Grayson Highway to New Hope Road) will begin by the end of 2007.

Arcado Road will be improved from Luxomni Road to Lilburn Industrial Way including improving both intersections with traffic signals, turn lanes, and sidewalks. The bridge over Jackson Creek will be replaced. This project is currently being designed.

Construction is underway on **Rockbridge Road** from east of Jimmy Carter Boulevard to Dickens Road. Improvements include a center turn lane and sidewalks on both sides of the roadway.

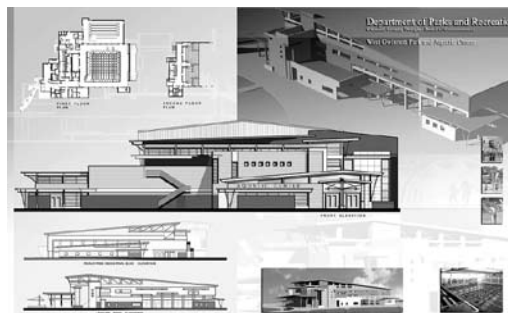

West Gwinnett Park

Parks and Recreation

Money from the 2005 SPLOST program was identified to build a new \$16.9 million park and aquatic center in western Gwinnett County on Peachtree Industrial Boulevard between Norcross and Berkeley Lake. Scheduled to open in spring 2008, the 22-acre **West Gwinnett Park** will feature an indoor aquatic center with a 25-yard x 25-meter competition pool, a 25-yard x 30-foot instructional pool, bleachers for 750 spectators, and an outdoor leisure pool. The park will also have a ¼-mile lighted walking track, comfort

station, and two lighted and fenced multi-purpose fields.

Club Drive Park is a \$2.7 million project scheduled to open in late 2008. Located in the central portion of Gwinnett County (Club Drive in Lawrenceville), this 25-acre park is highlighted by a lake and will include a ½-mile multi-purpose trail, fishing pier and gazebo on the lake, comfort station, two half-court basketball courts, playground, open lawn area, and two picnic shelters.

Duncan Creek Park is located in northern Gwinnett County off Braselton Highway near Pine Road in the Hamilton Mill area. This \$7.9 million, 109-acre park is scheduled to open in spring 2008 with amenities including a football complex with a concession/restroom building, press box, bleachers, lighted football field, and lighted ½-mile walking track around the field. Other amenities include a pavilion available for rent, half-court basketball court, comfort station, and playground. A teen area will feature a lighted skate park, comfort station, two lighted full-size and two half-court basketball courts, and three lighted sand volleyball courts.

Alexander Park is a \$6 million project that is scheduled to open by spring 2009. This 91-acre park in the south central part of Gwinnett County (Scenic Highway near Sugarloaf Parkway) features a plaza area with an amphitheater, an 18-hole disc golf course, open lawn area, playground, horseshoe pits, a pier to be built on the existing lake, restroom building, and three miles of natural surface and paved multi-purpose trails.

Libraries

Book lovers have three new branch libraries to choose from thanks to SPLOST. Branch libraries have opened in **Grayson**, **Dacula**, and **Suwanee** in the last three years. Design soon will be underway for the new **Hamilton Mill Branch Library**.