

DEPARTMENT OF TRANSPORTATION GWINNETT COUNTY

PLAN AND PROFILE OF PROPOSED GRAVEL SPRINGS ROAD / SR 324 @ I-85 / SR 403 INTERCHANGE

FEDERAL AID PROJECT
PI* 0012698
GWINNETT COUNTY

FEDERAL ROUTE * I-85
STATE ROUTE * 324 & 403
P.I. NO. 0012698



END PROJECT
PI* 0012698
STA. 430+00.00
N 1481537.1620
E 2369915.0463
FOR ADVANCE SIGNAGE
SR 403/I-85 SB
MP 119.36

NOTE:
ALL REFERENCES IN THIS DOCUMENT, WHICH INCLUDES ALL PAPERS, WRITINGS, DOCUMENTS, DRAWINGS, OR PHOTOGRAPHS USED, OR TO BE USED IN CONNECTION WITH THIS DOCUMENT, TO "STATE HIGHWAY DEPARTMENT OF GEORGIA," "STATE HIGHWAY DEPARTMENT," "GEORGIA STATE HIGHWAY DEPARTMENT," "HIGHWAY DEPARTMENT," OR "DEPARTMENT" WHEN THE CONTEXT THEREOF MEANS THE STATE HIGHWAY DEPARTMENT OF GEORGIA, AND SHALL BE DEEMED TO MEAN THE DEPARTMENT OF TRANSPORTATION.

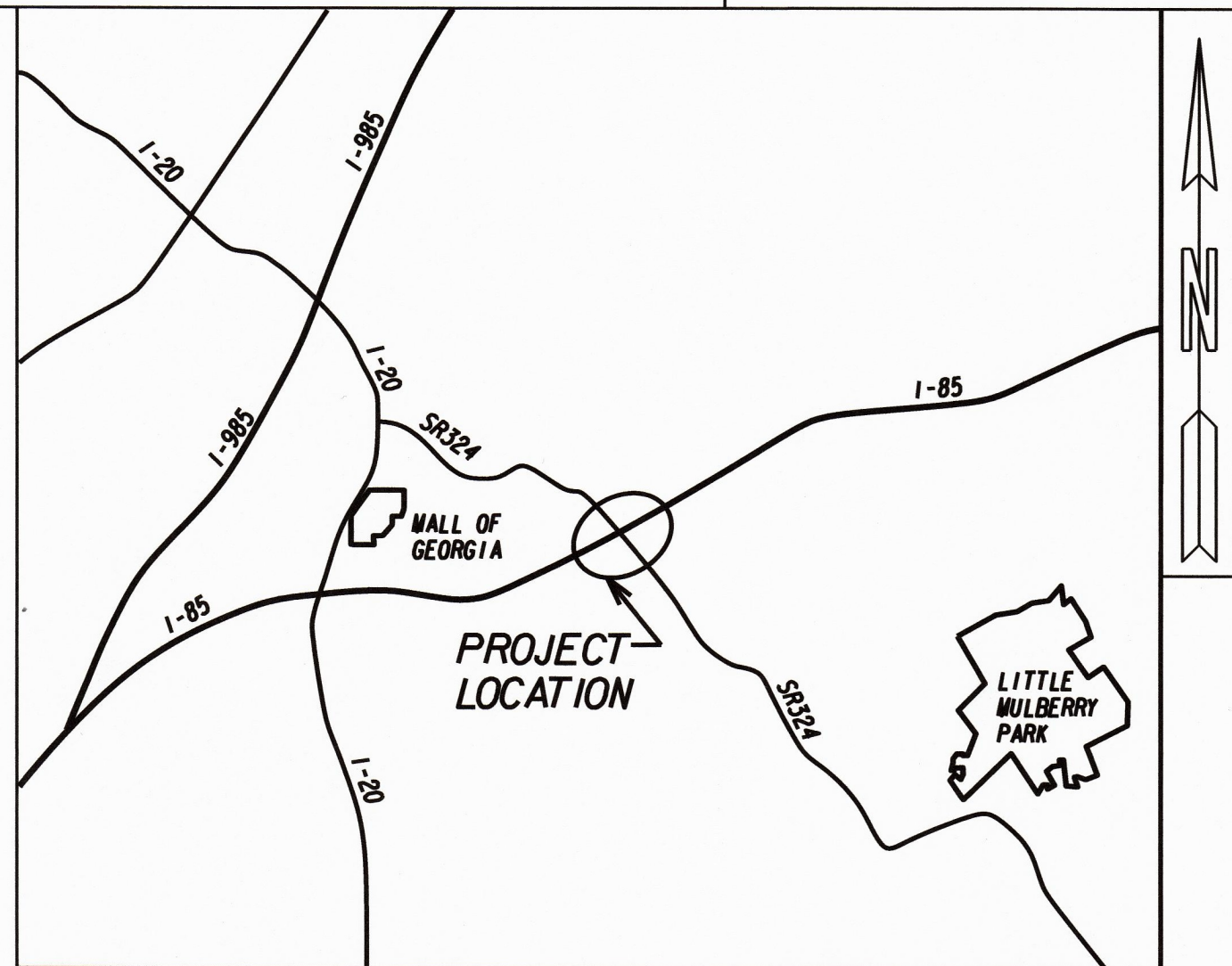

LOCATION SKETCH

DESIGN DATA: I-85/SR 403
TRAFFIC A.D.T.: 80,500 (2020)
TRAFFIC A.D.T.: 105,650 (2040)
TRAFFIC D.H.V.: 7,825 (2040)
DIRECTIONAL DIST: 50/50
% TRUCKS: 10.5%
24 HR. TRUCKS %: 19%
SPEED DESIGN: I-85/SR 403: 70mph
SPEED DESIGN: Gravel Springs Rd./ SR 324: 45 mph
[SPEED DESIGN: Ramps: 60 mph/45 mph]

LOCATION & DESIGN
APPROVAL DATE: 5-03-2017
FUNCTIONAL CLASS:
I-85/SR 403 - Urban Interstate
SR 324/ Gravel Springs Road - Urban Minor Arterial
THIS PROJECT IS 100% IN GWINNETT COUNTY AND IS 100% IN CONG. DIST. NO. 7.
PROJECT DESIGNATION: PROJECT OF DIVISION INTEREST

THIS PROJECT HAS BEEN PREPARED USING THE HORIZONTAL GEORGIA COORDINATE SYSTEM OF 1984 (NAD 1983/94 WEST ZONE, AND THE NORTH AMERICAN VERTICAL DATUM (NAVD) OF 1988.

MIDPOINT STA. 282+16.00
N=1475690.8952 E=2356379.0581

THE DATA TOGETHER WITH ALL OTHER INFORMATION SHOWN ON THESE PLANS OR IN ANYWAY INDICATED THEREBY, WHETHER BY DRAWINGS OR NOTES, OR IN ANY OTHER MANNER, ARE BASED UPON FIELD INVESTIGATIONS AND ARE BELIEVED TO BE INDICATIVE OF ACTUAL CONDITIONS. HOWEVER, THE SAME ARE SHOWN AS INFORMATION ONLY, ARE NOT GUARANTEED, AND DO NOT BIND THE DEPARTMENT OF TRANSPORTATION IN ANY WAY. THE ATTENTION OF BIDDER IS SPECIFICALLY DIRECTED TO SUBSECTIONS 102.04, 102.05, AND 104.03 OF THE SPECIFICATIONS.

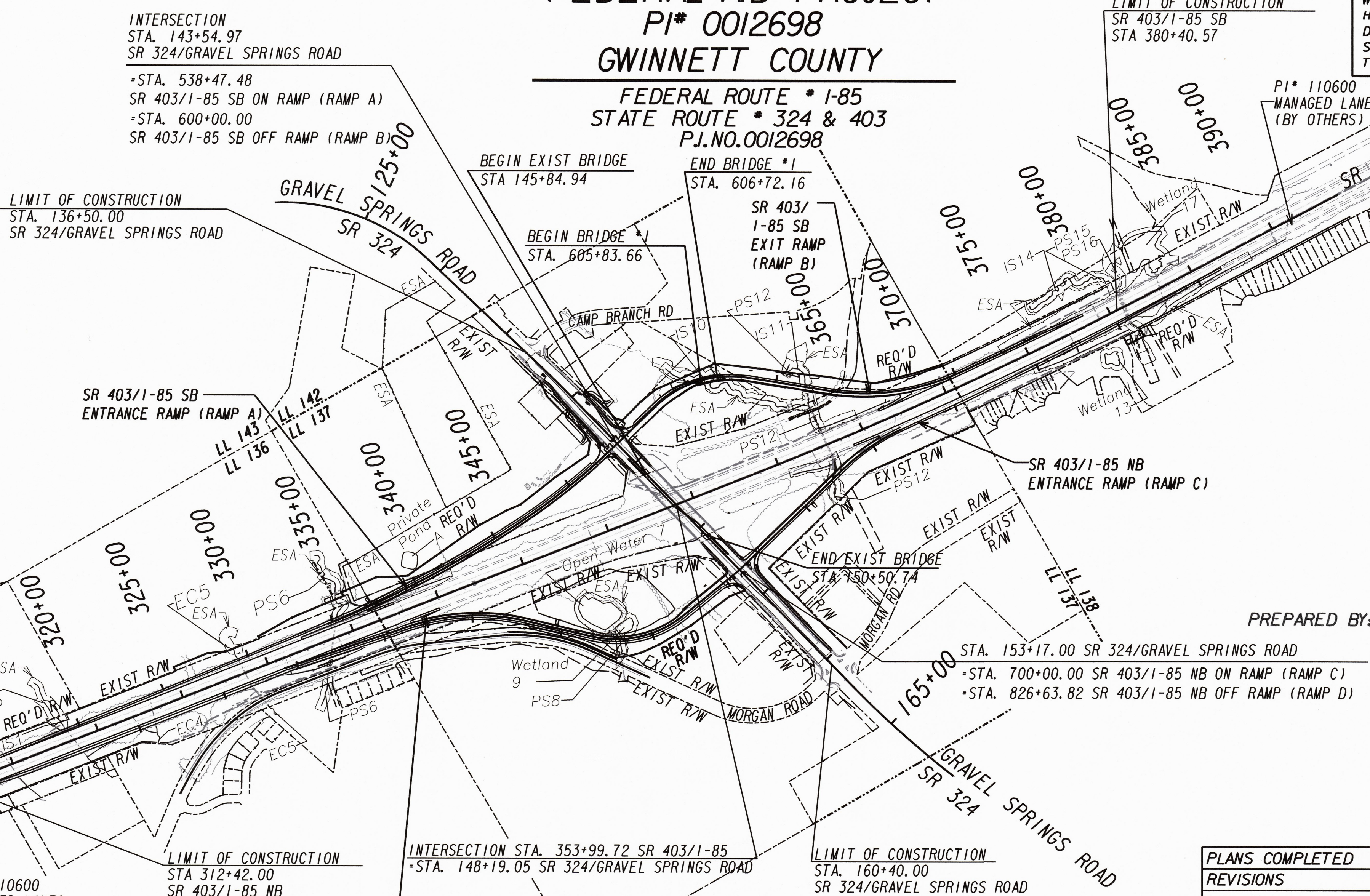

PLANS PREPARED BY:



GRESHAM SMITH AND PARTNERS

GRESHAM, SMITH & PARTNERS
2325 LAKEVIEW PARKWAY
ALPHARETTA, GA 30009
PHONE No. (770) 754-0755



PREPARED BY:
ANDREW M. FARMER, P.E.
GRESHAM SMITH AND PARTNERS

LENGTH OF PROJECT		COUNTY No. 135 GWINNETT COUNTY Project No. PI* 0012698
		MILES
NET LENGTH OF ROADWAY	5.600	
NET LENGTH OF BRIDGES (RAMP B)	0.022	
NET LENGTH OF PROJECT	5.600	
NET LENGTH OF EXCEPTIONS	0.000	
GROSS LENGTH OF PROJECT	5.600	

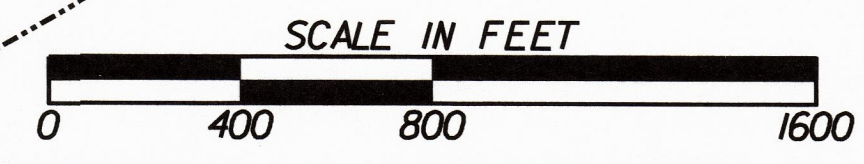

PLANS COMPLETED	2-22-2019
REVISIONS	

NOTE: THIS PROJECT INCLUDES POST CONSTRUCTION BMP'S

DRAWING No.
01-0001